

38 SERIES OFFSET ASSEMBLY

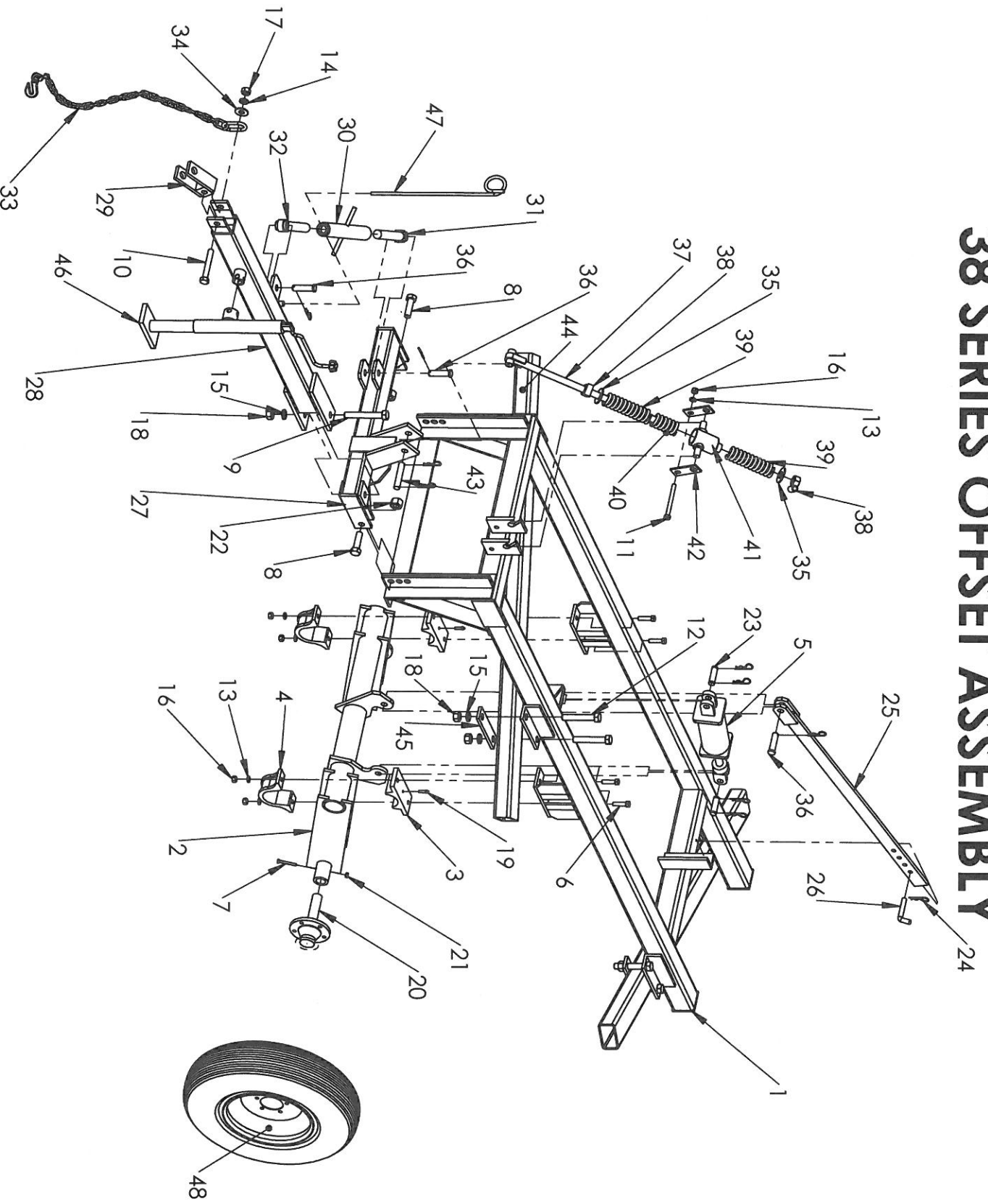

38 SERIES OFFSET ASSEMBLY

ITEM NO.	PART NUMBER	DESCRIPTION
1	15789	38 OFFSET FRAME WELDMENT
2	15790	WHEEL CARRIAGE WELDMENT
3	T-58	WHEEL CARRIAGE BEARING TOP
4	T-57	WHEEL CARRIAGE BEARING BOTTOM
5	10610	CYLINDER
6	9192	HEX BOLT, 5/8" X 2 1/2" GR. 5
7	T-895	HEX BOLT, 3/8" X 3" GR. 5
8	T-780	HEX BOLT, 1" X 3 1/2" GR. 5
9	13254	HEX BOLT, 1" X 7" GR. 5
10	15567	HEX BOLT, 7/8" X 6" GR. 5
11	T-749	HEX BOLT, 5/8" X 6 1/2" GR. 5
12	15349	HEX BOLT, 1" X 6" GR. 5
13	T-24	LOCK WASHER, 5/8"
14	T-21	LOCK WASHER, 7/8"
15	T-34	LOCK WASHER, 1"
16	T-22	HEX NUT, 5/8"
17	T-19	HEX NUT, 7/8"
18	T-18A	LOCK NUT, 1"
19	12511	EXTENDED GREASE FITTING
20	13630	SPINDLE & HUB ASSY.
21	12899	FLANGE LOCKNUT, 3/8"
22	T-18A	LOCK NUT, 1 1/8"
23	15374	CYLINDER PIN
24	9979	COTTOR HAIR PIN
25	15791	DEPTH CONTROL BAR
26	9690	DEPTH CONTROL PIN
27	11378	DRAWBAR WELDMENT
28	11380	TONGUE WELDMENT
29	T-2665	TONGUE CLEVIS WELDMENT
30	9876	TURNBUCKLE BARRELL 24"
31	11470	LH ADJUSTING SCREW, 12"
32	11469	RH ADJUSTING SCREW, 12"
33	15186	SAFETY CHAIN
34	15569	FLAT WASHER, 7/8"
35	T-698	FLAT WASHER, 1 1/8"
36	13311	PIN, 1" X 3 1/2"
37	11596	LEVELING ROD SCREW, 31"
38	T-699	WING NUT
39	T-509	ADJUSTING SPRING 8 1/2"
40	T-511	ADJUSTING SPRING 4 1/2"
41	T-510	SPRING HOUSING
42	9006	RETAINER STRAP
43	T-934	PIN, 1" X 5"
44		GANG BEAM SEE CHART
45	15792	GANG STRAP
46	T-933	TONGUE JACK
47	T-465	HOSE HOLDER
48	16000	TIRE AND RIM ASSY

38 OFFSET GANG BEAM CHART

PART NUMBER	DESCRIPTION	ITEM NO.
T-1001	5" X 3" RECT. TUBE X 63"	38/916 & 38/1014
11686	5" X 3" RECT. TUBE X 72"	38/918
11603	5" X 3" RECT. TUBE X 74"	38/1016
T-1003	5" X 3" RECT. TUBE X 81"	38/920
11604	5" X 3" RECT. TUBE X 84"	38/1018
T-1005	5" X 3" RECT. TUBE X 90"	38/922
11605	5" X 3" RECT. TUBE X 95"	38/1020
T-1007	5" X 3" RECT. TUBE X 99"	38/924
11606	5" X 3" RECT. TUBE X 105"	38/1022
11607	5" X 3" RECT. TUBE X 116"	38/1024
11687	5" X 3" RECT. TUBE X 117"	38/928